

SAVOIR

AUTHENTICITY

A union of Savile Row tailoring with Savoir's craftsmanship in a celebration of British design.



The headboard is upholstered in bespoke woven leather designed by Oswald Boateng and created by Alma, reinterpreting traditional Kente cloth — a sacred textile from Ghana and a hallmark of his work.

The base is upholstered in Whistler Leather's embossed 'Tangier Onyx' full-grain leather, while the reverse of the headboard is finished in Dedar — Tabularasa Col. 163 Smeraldo.

No.2 bed set.

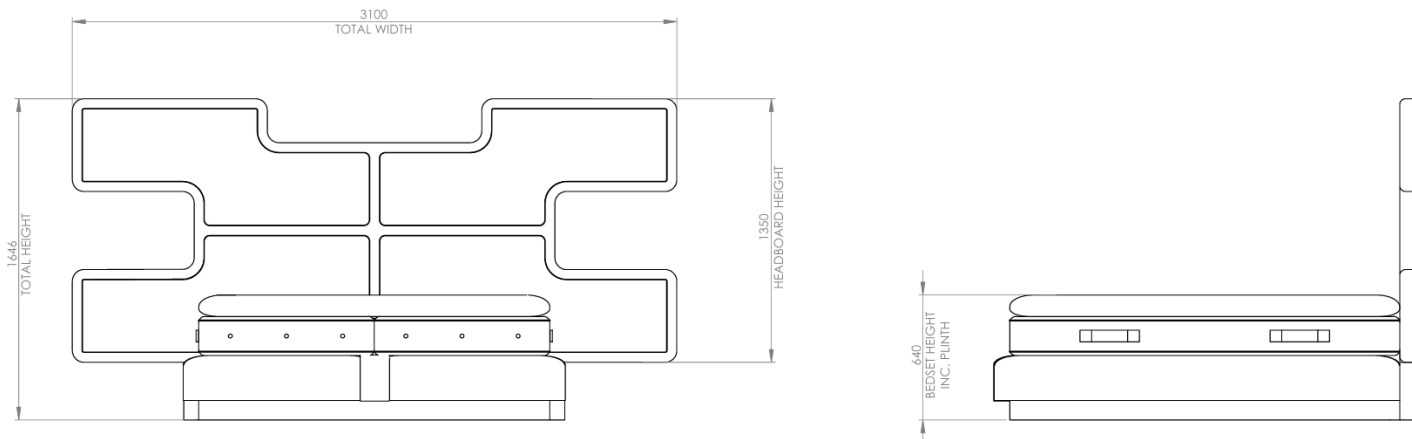

SAVOIR

UK (cm)

SIZE:	HEADBOARD WIDTH	BEDSET DEPTH	TOTAL LENGTH	BEDSET WIDTH	BEDSET LENGTH	LEG HEIGHT	TOTAL HEIGHT
SUPER KING	510cm	54cm	216cm	196cm	208cm	10cm	165cm

US (in)

SIZE:	HEADBOARD WIDTH	BEDSET DEPTH	TOTAL LENGTH	BEDSET WIDTH	BEDSET LENGTH	LEG HEIGHT	TOTAL HEIGHT
KING	127 ¼"	21 ¼"	86 ¼"	82 ¼"	83"	4"	65"

FABRICS

We have travelled the world seeking the finest upholstery fabrics, from William Morris inspired jacquards to exquisite Italian-made cotton velvets. Our design team have an encyclopaedic knowledge of fabric and will source the perfect fabric for you, whether it is leather, linen, mohair, horsetail hair, pure wool, a delicate silk, or a unique vintage piece. Please check with our team regarding fabric availability for this design. Currently, it is only available in one fabric.

LEGS

Elevating a bed creates a more airy, welcoming environment. At Savoir you can select from minimalist hardwood blocks, contemporary metals such as bronze or chrome, hand carved rosewood and Georgian style with brass cups. Alternatively, you can commission our craftspeople to reproduce a classic design or create something completely unique.

CONTACT DETAILS

You'll find the contact details for each of our showrooms on our website, and you can email us at info@savoirbeds.co.uk.
