

# SAVOIR

## WINCH DESIGN – TRANQUILITY

---

A collaboration inspired by their dedication to extraordinary craftsmanship and harmonious interiors. Blending timeless elegance with modern sophistication.



Upholstered in a buttery-soft leather from Foglizzo which is complemented by a figured anegre timber trim.  
No 4 Savoir spring base

---

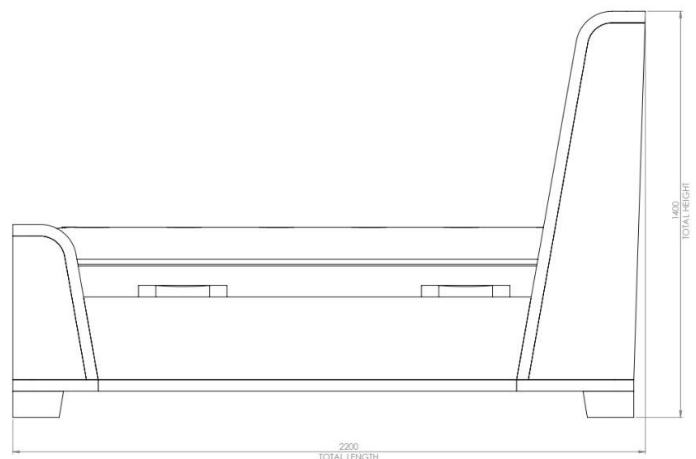
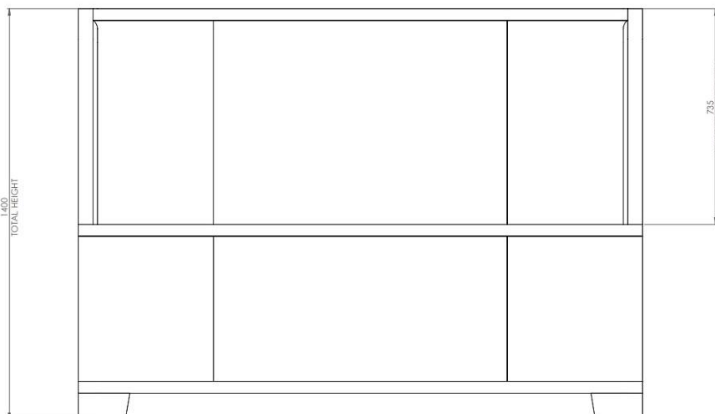

# SAVOIR

---

## UK (cm)

SIZE:	HEADBOARD WIDTH	BEDSET DEPTH	TOTAL LENGTH	BEDSET WIDTH	BEDSET LENGTH	LEG HEIGHT	TOTAL HEIGHT
SUPER KING	194cm	51.5cm	220cm	180cm	200cm	15cm	140cm

---

## US (inches)

SIZE:	HEADBOARD WIDTH	BEDSET DEPTH	TOTAL LENGTH	BEDSET WIDTH	BEDSET LENGTH	LEG HEIGHT	TOTAL HEIGHT
KING	81"	20"	88"	76"	80"	6"	55"

---

## FABRICS

We have travelled the world seeking the finest upholstery fabrics, from William Morris inspired jacquards to exquisite Italian-made cotton velvets. Our design team have an encyclopedic knowledge of fabric and will source the perfect fabric for you, whether it is leather, linen, mohair, horsetail hair, pure wool, a delicate silk, or a unique vintage piece.

---

## LEGS

Elevating a bed creates a more airy, welcoming environment. At Savoir you can select from minimalist hardwood blocks, contemporary metals such as bronze or chrome, hand carved rosewood and Georgian style with brass cups. Alternatively you can commission our craftspeople to reproduce a classic design or create something completely unique.

---

## CONTACT DETAILS

For further information, please view our showrooms page for contact details or alternatively, email [info@savoirbeds.co.uk](mailto:info@savoirbeds.co.uk).

---